

GENERAL TECHNICAL CHARACTERISTICS

Reference standards : IEC 61071-60068
 Dielectric : Polypropylene film
 Construction : Metallized film with internal series connection ,
 Dry construction filled by solid resin, Non-inductive type
 Coating : Aluminum case
 Leads: Threaded bold, M10

ELECTRICAL CHARACTERISTICS

Operating temperature range : - 40 to + 85 °C (case)
 Capacitance : 0.22 to 11.0µF
 Rated Voltage : 2400 to 8000 VDC
 Tolerance : ± 5% , ± 10%
 Dissipation factor: 5×10^{-4} Measured at 1000±20 Hz and 25±5°C
 Life expectancy : 100,000 hours at Un and 70 °C
 (Hot-spot temperature)

TEST METHODS AND PERFORMANCES

Dielectric strength: 1.5Un (DC) applied for 10s
 at 25±5°C (1 minute for type test)
 Test voltage terminal to case : (2xUrms+1000) Vac, Min 3000Vac 60s at 25 °C
 Insulation resistance : 10,000 s but need greater than 10,000MΩ

ORDERING CODE

Please refer to Page 8, item I

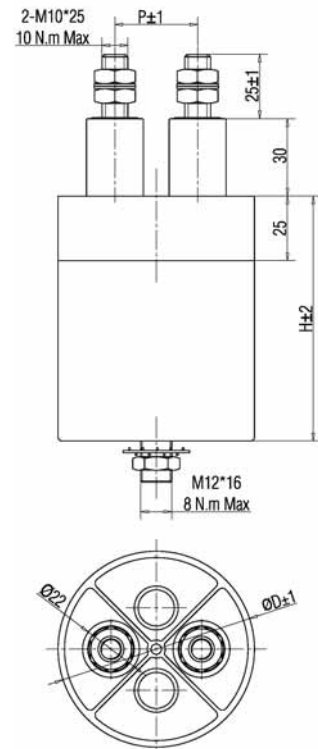

Electrical specifications, ordering codes

Ordering Code	Cap (µF)	Dimension (mm)			I _{rms} @25°C @10kHz (A)	du/dt (v/µs)	I _{peak} (A)	L _s (nH)	ESR@10kHz (mΩ)
		D	H	P					
Un 2400VDC , Urms 1200VAC , Upeak 1680V , Us 3600V									
SDH-2400-1.5-MS	1.5	76	70	35	35	800	1200	< 50	1.9
SDH-2400-2.2-MS	2.2	76	70	35	40	800	1760	< 50	1.4
SDH-2400-3.0-MS	3.0	86	70	35	45	800	2400	< 50	1.1
SDH-2400-4.7-MS	4.7	76	125	35	55	800	3760	< 50	0.8
SDH-2400-6.0-MS	6.0	86	125	35	65	800	4800	< 50	0.7
SDH-2400-11-MS	11	116	130	50	80	800	8800	< 50	0.5
Un 3600VDC , Urms 1800VAC , Upeak 2520V , Us 5400V									
SDH-3600-1.0-MS	1.0	76	95	35	32	1000	1000	< 50	2.7
SDH-3600-1.5-MS	1.5	76	95	35	40	1000	1500	< 50	1.9
SDH-3600-2.0-MS	2.0	86	95	35	45	1000	2000	< 50	1.5
SDH-3600-3.0-MS	3.0	76	175	35	50	1000	3000	< 50	1.1
SDH-3600-4.0-MS	4.0	86	175	35	65	1000	4000	< 50	0.9
SDH-3600-7.5-MS	7.5	116	180	50	80	1000	7500	< 50	0.6
Un 4800VDC , Urms 2400VAC , Upeak 3360V , Us 7200V									
SDH-4800-0.68-MS	0.68	76	120	35	30	1200	816	< 50	3.8
SDH-4800-1.0-MS	1.0	76	120	35	38	1200	1200	< 50	2.7
SDH-4800-1.5-MS	1.5	86	120	35	42	1200	1800	< 50	1.9
SDH-4800-2.2-MS	2.2	76	225	35	48	1200	2640	< 50	1.4
SDH-4800-3.0-MS	3.0	86	225	35	60	1200	3600	< 50	1.1
SDH-4800-5.6-MS	5.6	116	230	50	80	1200	6720	< 50	0.7
Un 6000VDC , Urms 3000VAC , Upeak 4200V , Us 9000V									
SDH-6000-0.68-MS	0.68	76	145	35	32	1500	1020	< 50	3.8
SDH-6000-0.82-MS	0.82	76	145	35	37	1500	1230	< 50	3.2
SDH-6000-1.2-MS	1.2	86	145	35	40	1500	1800	< 50	2.3
SDH-6000-1.8-MS	1.8	76	275	35	45	1500	2700	< 50	1.6

Electrical specifications, ordering codes

Ordering Code	Cap (μ F)	Dimension (mm)			I _{rms} @25°C @10kHz (A)	du/dt (v/ μ s)	I _{peak} (A)	L _s (nH)	ESR@10kHz (m Ω)
		D	H	P					
Un 6000VDC , Urms 3000VAC , Upeak 4200V , Us 9000V									
SDH-6000-2.4-MS	2.4	86	275	35	60	1500	3600	< 50	1.3
SDH-6000-4.5-MS	4.5	116	275	50	80	1500	6750	< 50	0.8
Un 8000VDC , Urms 4000VAC , Upeak 5600V , Us 12000V									
SDH-8000-0.22-MS	0.22	76	135	35	33	3000	660	< 50	5.8
SDH-8000-0.33-MS	0.33	76	135	35	40	3000	990	< 50	4.0
SDH-8000-0.47-MS	0.47	86	135	35	45	3000	1410	< 50	2.9
SDH-8000-0.68-MS	0.68	76	260	35	50	3000	2040	< 50	2.1
SDH-8000-1.0-MS	1.0	86	260	35	60	3000	3000	< 50	1.5
SDH-8000-1.8-MS	1.8	116	260	50	80	3000	5400	< 50	1.0